



PRODUCT SPECIFICATION

**PCB Power
Relays**

290

Series

290 Series PCB Power Relays

WERNER

Features

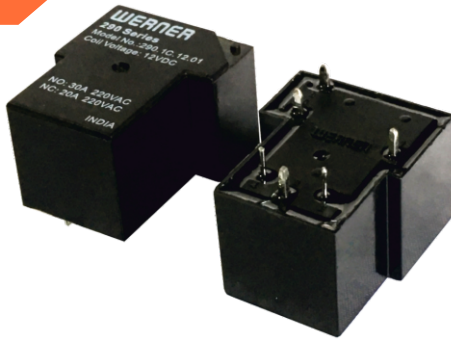

30A Switching Capability
 4.8kV Dielectric strength
 Class F Insulation available
 Open type and sealed type available
 Environmental friendly(RoHS compliant)
 Outline Dimension (32.4 x 27.5 x 20)mm

Contact Data

Contact Arrangement	1A - NO	1B - NC	1C
Contact Resistance	50mΩ(1A 24VDC)		
Contact Material	AgSnO ₂ , AgCdo		
Max. switching capacity	7200VA/900W	4800VA/600W	4500VA/600W
Max. switching voltage	250VAC/30VDC		
Max. switching current	30A	20A	NO:30A/NC:20A
Rating	30A 240VAC	20A 240VAC	20A 240VAC
Mechanical endurance	1 x 10 ⁷		
Electrical endurance	1 x 10 ⁹		

Characteristics

Insulation Resistance	1000MΩ (500VDC)
Between coil & contacts	4500 1min
Between open contacts	1500V 1min
Operate time (at rated voltage)	≤15ms
Release time (at rated voltage)	≤10ms
Storage temperature range	-40° C-105° C
Functional	100m/s ² (10g)
Destructive	1000m/s ² (100g)
Vibration resistance	10Hz-55Hz 1.5mm
Humidity	5%-85% RH
Termination	PCB
Unit weight	Approx 36g

Coil Data Type

Coil Voltage VDC	Pick-up Voltage VDC	Drop-out Voltage VDC	Max. Allowable Voltage VDC	Coil Resistance Ω
5	2.1	0.45	6.5	27 x (1±10%)
6	4.2	0.6	7.8	40 x (1±10%)
9	6.75	0.9	11.7	97x (1±10%)
12	8.00	2.2	15.6	155x (1±10%)
24	16.8	3.4	31.2	660x (1±10%)
110	77.00	16.5	143	13450x (1±10%)
220/240	192	48	286	13490x (1±10%)

ORDERING TABLE

290.01.A.12.02.01

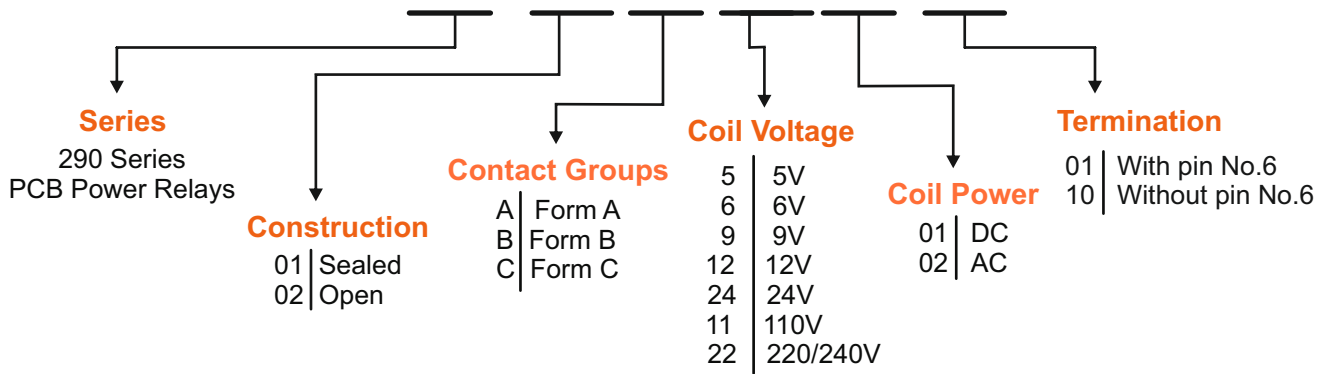

Dimension & Wiring Diagram

Outline Dimension

Wiring Diagram (Bottom view)

PCB Layout (Bottom view)

1 Form A Close type - (NO)

With 6# terminal

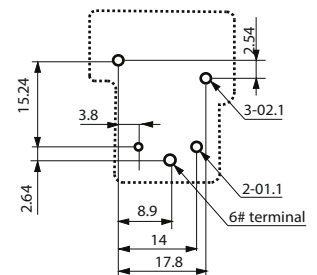
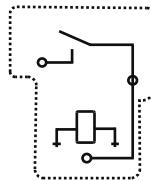
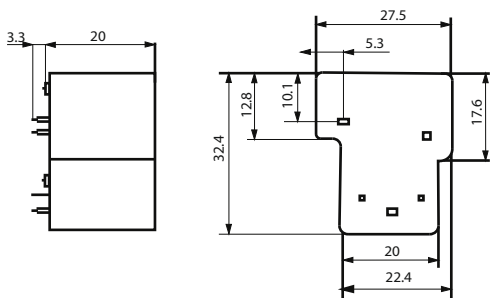

Without 6# terminal

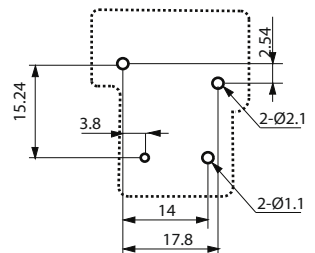
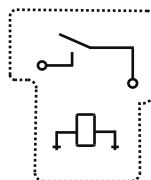
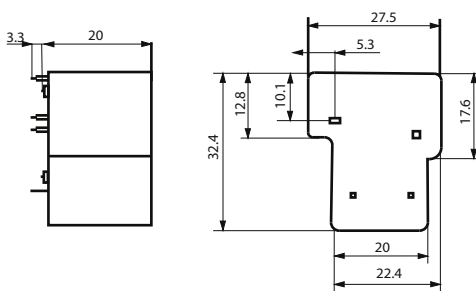

Dimension & Wiring Diagram

Outline Dimension

Wiring Diagram (Bottom view)

PCB Layout (Bottom view)

1 Form B Close type - (NC)

With 6# terminal

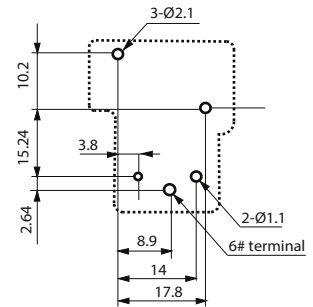
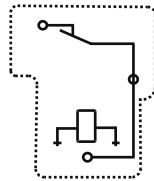
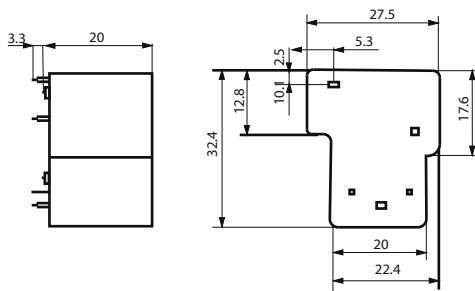

Without 6# terminal

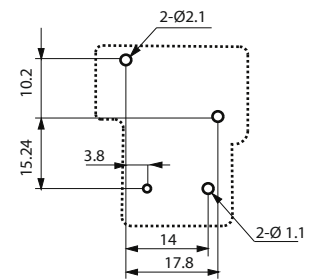
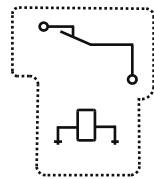
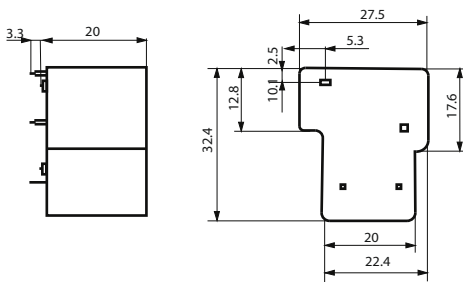

1 Form C Close type - (SPDT)

With 6# terminal

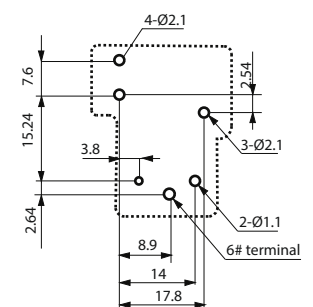
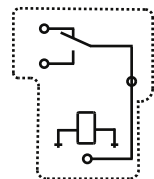
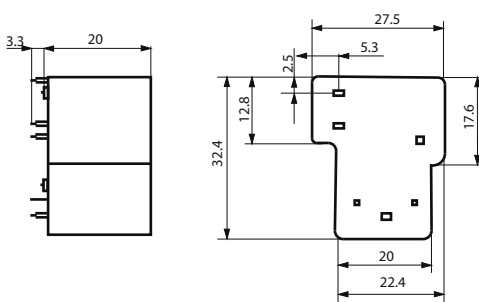

Without 6# terminal

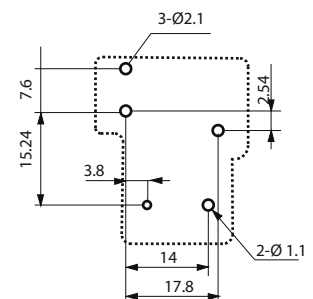
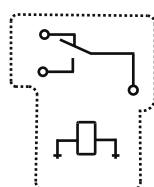
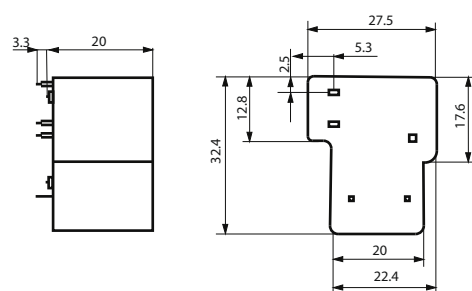

Dimension & Wiring Diagram

Outline Dimension

Wiring Diagram (Bottom view)

PCB Layout (Bottom view)

1 Form A Open type - (NO)

With 6# terminal

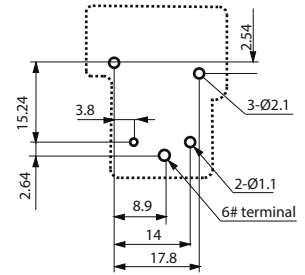
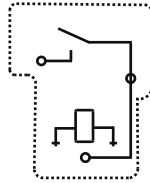
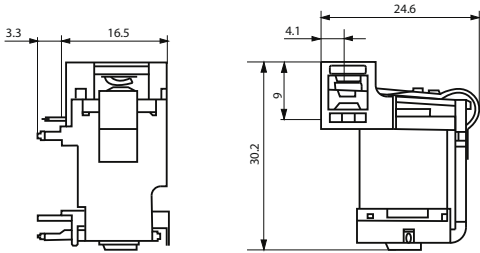

Without 6# terminal

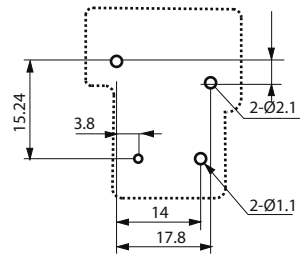
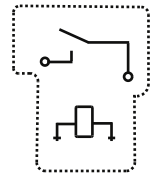
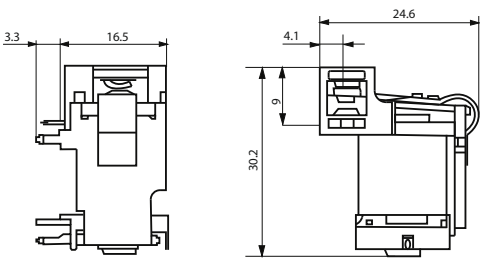

1 Form B Open type - (NC)

With 6# terminal

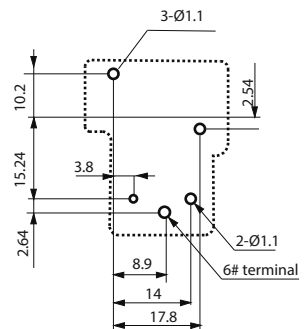
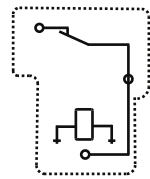
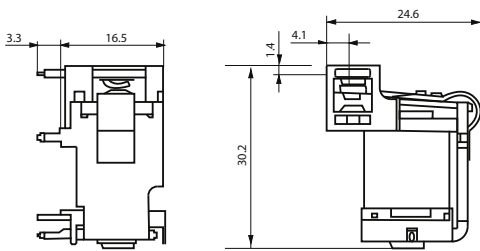

Without 6# terminal

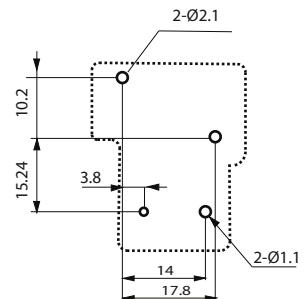
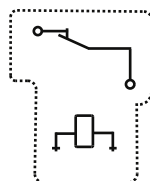
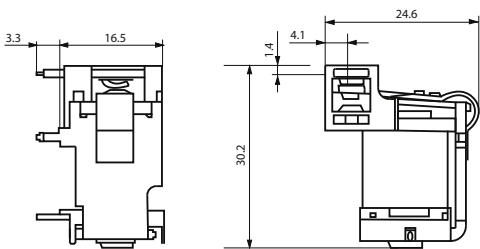

Dimension & Wiring Diagram

Outline Dimension

Wiring Diagram (Bottom view)

PCB Layout (Bottom view)

1 Form C Open type - (SPDT)

With 6# terminal

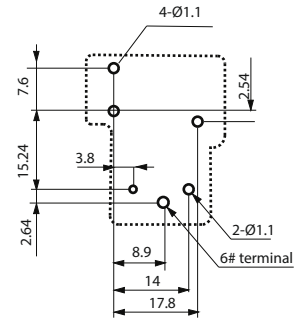
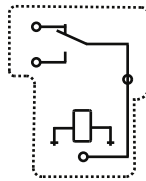
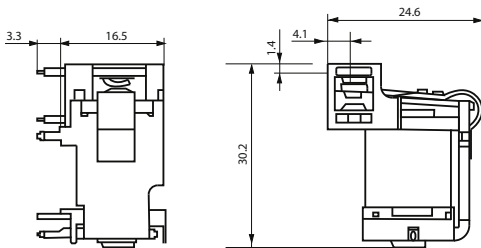

Without 6# terminal

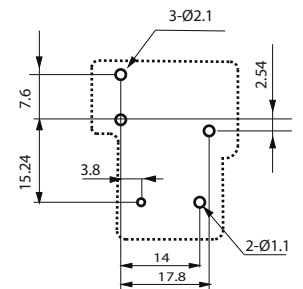
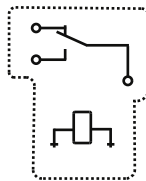
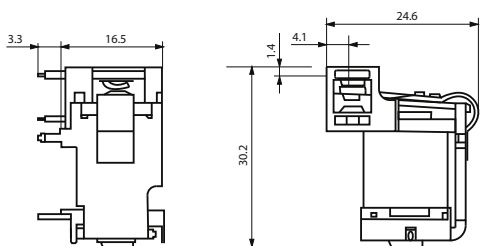

Living Industrial Partnerships

WERNER

Werner Electric Pvt Ltd

Plot no 166, Hebbal Industrial area,
Mysore-570016
India

www.wernerelektrik.com